

# JS500 Additional User's Manual

JS500-UM-551 1st

## Standard accessory of Ink Cleaning Solution Bottles

Two solution bottles accompany the product. Please utilize the correct solution bottle for the ink cartridge used.

- MK-00006: Solvent Ink Cleaning Solution (For IJ-81000 series ink cartridges)
- MK-00007: Eco solvent Ink Cleaning Solution (For IJ-81050 series ink cartridges)

## Standard accessory of the Cleaning Roller

Two cleaning rollers accompany the product.

If you change the ink cartridge series used, please replace the cleaning roller.

## When Changing the Ink to other series

When changing the ink cartridge in use from the solvent ink (IJ-18000 series) to the eco solvent ink (IJ-81050 series), or vice-versa, please follow the steps outlined below and reinstall the ink.

### Outline

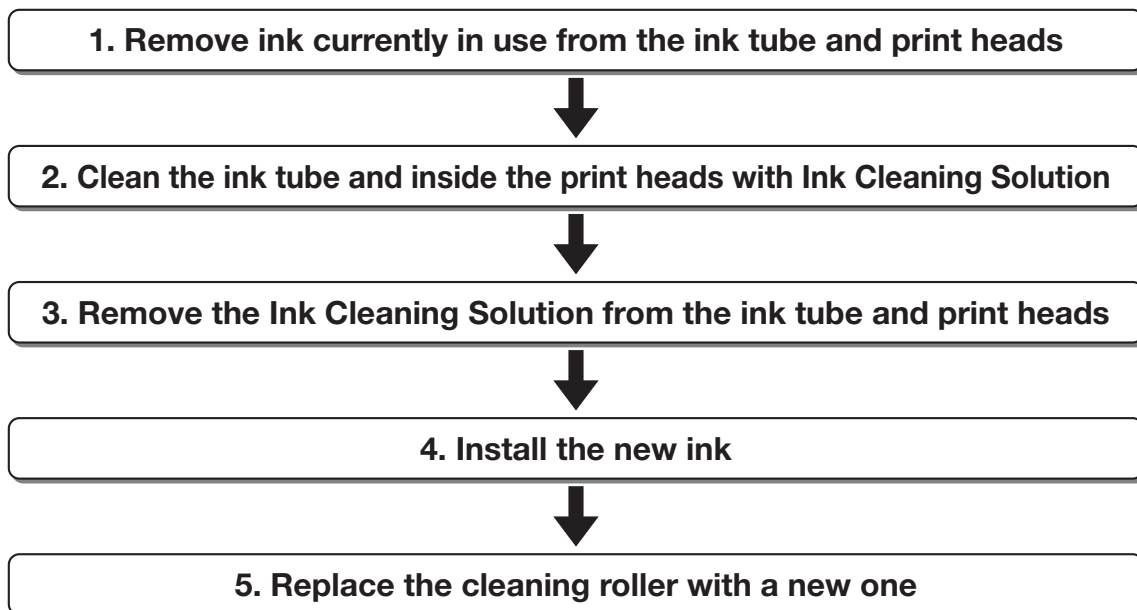

### Procedure

#### 1. Remove ink currently in use from the ink tube and print heads

Remove the ink, following steps in “3. Remove the cleaning solution (or Ink) from the ink tubes” of the Set up Guide.

## **2. Clean the ink tube and inside the print heads with Ink Cleaning Solution**

Clean the ink tube and inside the print heads using the Ink Cleaning Solution, following steps in “2.Clean the ink tube” of the Set up Guide.

### **CAUTION**

**When cleaning the ink tube, please use Ink Cleaning Solution from the same series as the newly used ink cartridge.**

- **When newly using an IJ-81000 ink cartridge: Clean with IJ-81000S**
- **When newly using an IJ-81050 ink cartridge: Clean with IJ-81050S**

## **3. Remove the Ink Cleaning Solution from the ink tube and print heads**

Remove the Ink Cleaning Solution, following steps outlined in “3. Remove the cleaning solution (or Ink) from the ink tubes” of the Set up Guide.

## **4. Install the new ink**

Install the new ink, following steps outlined in “4.Filling the ink to the tube” of the Set up Guide.

## **5. Replace the cleaning roller with a new one**

Replace the cleaning roller, following steps outlined in “9.2 Replacing the Cleaning Roller” of the User’s manual.

### **CAUTION**

**When dipping the cleaning roller into Ink Cleaning Solution, please use a solution bottle from the same series as the newly used ink cartridge.**

- **When newly using an IJ-81000 ink cartridge: Clean with MK-00006**
- **When newly using an IJ-81050 ink cartridge: Clean with MK-00007**

## **Regarding Solution Bottles Used for Daily Maintenance or Print Head Maintenance**

Please use a solution bottle from the same series as the newly used ink cartridge when using solution bottles for purposes such as daily maintenance or print head maintenance.

---